

Soils Map

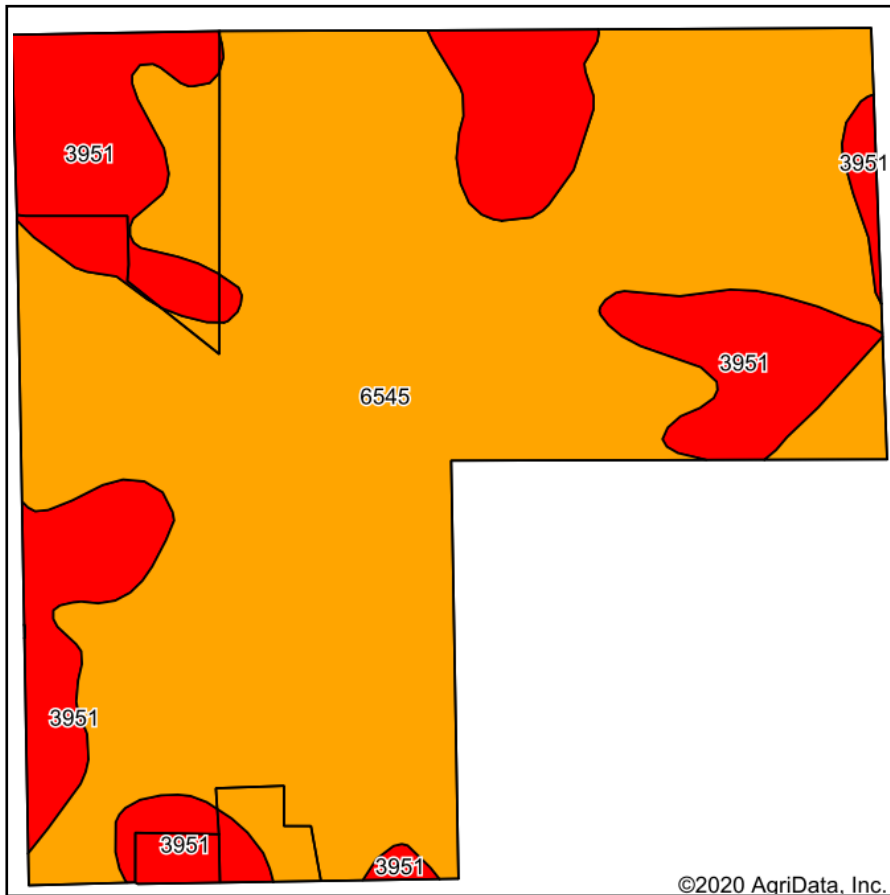

Soils data provided by USDA and NRCS.

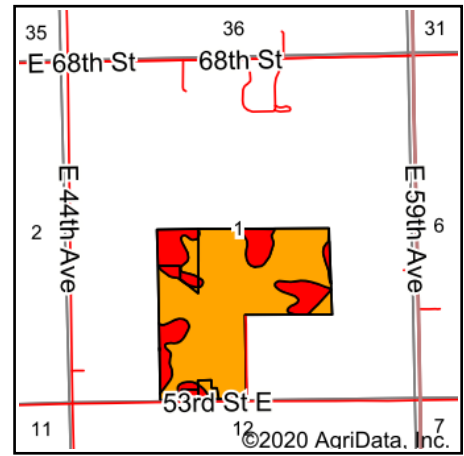

State: **Nebraska**
 County: **Platte**
 Location: **1-17N-1E**
 Township: **Columbus**
 Acres: **119.69**
 Date: **12/4/2020**



Maps Provided By:



Code	Soil Description	Acres	Percent of field	SRPG Legend	Non-Irr Class *c	Irr Class *c	SRPG	Alfalfa hay	Alfalfa hay Irrigated	Corn	Corn Irrigated	Grain sorghum	Soybeans	Soybeans Irrigated	*n NCCPI Soybeans
6545	Moody silty clay loam, terrace, 0 to 2 percent slopes	91.07	76.1%		Ile	Ile	76								72
3951	Fillmore silt loam, occasionally ponded	28.62	23.9%		IIIw	IVw	34	2	4	55	94	61	26	37	57
Weighted Average							66	0.5	1	13.2	22.5	14.6	6.2	8.8	*n 68.4

*n: The aggregation method is "Weighted Average using all components"

*c: Using Capabilities Class Dominant Condition Aggregation Method

Soils data provided by USDA and NRCS.